

STRATLOCK RAIL SYSTEM

BY FASTMOUNT

Setting the standard for panel mounting

INSTALLATION GUIDE

SL-RCA180 How to fit connector - building a wall to ceiling connection

SL-RCA180



USE WITH:

- SL-RCF90 Grub screws (supplied)
- Socket screws (supplied)
- 2.5mm hex key
- 3mm hex key



| | | |
|---|--|--|
| <p>Remove grub screws from teeth of SL-RCF90</p> | <p>Slide SL-RCF90 into groove of horizontal SL-RLE</p> | <p>Tighten grub screws with 2.5mm hex key once in position</p> |
| <p>Insert SL-RCA180 into profile end of vertical SL-RLE</p> | <p>Tighten grub screws with 2.5mm hex key</p> | <p>Insert SL-RCF90 into SL-RCA180</p> |
| <p>Insert socket screws and fasten enough to hold connectors together</p> | <p>Adjust horizontal rail to desired angle, tighten socket screws with 3mm hex key</p> | |

Creating and decorating aluminium framework has never been faster or more flexible. With only one profile required and adaptable connectors, the Stratlock Rail System is a foolproof way to create a consistent substrate for the perfect panel finish. For further information or technical support contact: info@fastmount.com

info@fastmount.com

www.fastmount.com

*Specification subject to change without notice, see website for updates.
 INSTALLATION GUIDE SL-RCA180 Wall to ceiling/ 10/21 Copyright © Fastmount Ltd.

 PROUDLY DESIGNED IN NEW ZEALAND

STRATLOCK RAIL SYSTEM

BY FASTMOUNT

Setting the standard for panel mounting

INSTALLATION GUIDE

SL-RCA180 How to connect a ceiling to wall grid

SL-RCAB180



USE WITH:

- SL-RCF90 Grub screws (supplied)
- Socket screws (supplied)
- Appropriate ceiling hangers
- 2.5mm hex key
- 3mm hex key



Position appropriate amount of SL-RCF90 connectors along groove of SL-RLE. Tighten grub screws with 2.5mm hex key to secure.

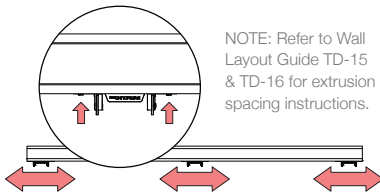

NOTE: Refer to Wall Layout Guide TD-15 & TD-16 for extrusion spacing instructions.

Insert SL-RCA180 into profile end of vertical SL-RLE. Tighten grub screws with 2.5mm hex key to secure.

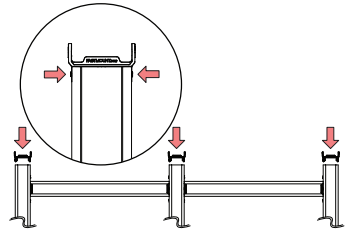

Insert SL-RCF90 into SL-RCA180, insert socket screws and adjust to desired angle.

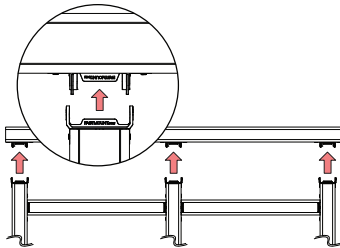

Adjust horizontal profile to desired position. Tighten socket screws with 3mm hex key to secure position.

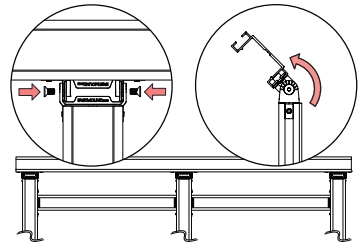

Creating and decorating aluminium framework has never been faster or more flexible. With only one profile required and adaptable connectors, the Stratlock Rail System is a foolproof way to create a consistent substrate for the perfect panel finish. For further information or technical support contact: info@fastmount.com

info@fastmount.com

www.fastmount.com

*Specification subject to change without notice, see website for updates.
INSTALLATION GUIDE SL-RCA180 Ceiling to wall/ 10/21 Copyright © Fastmount Ltd.

 PROUDLY DESIGNED IN NEW ZEALAND